

Other models in this range:
 MV306 - MV426 - MV430
 MV456 - MV460
 MV806 - MV1006

MV Cube Ice Machines up to 320 Kg



MV 606 with SB393 (sold separately)



MV606+SB393 (sold separately)



MV606+SB530 (sold separately)



MV606+SB550+Top (sold separately)

CBT42EMCD



MV606+SB948+Top (sold separately)



MV606+SB1025+Top (sold separately)

CBT52EAMCD



MV606+UBH1100 (sold separately)



MV606+UBH1600 (sold separately)



MV606+SIS700 (sold separately)

This product qualifies for the following listings:



Standard Features

- **"Global Standard" width-** 30" (76.20 cm) wide
- **Auto-Alert indicator lights-** communicate about operating status: a diagnostic LED light guides the troubleshooting process and helps decisions regarding opening a service call.
- **Front-facing Evaporator-** Ice forming process inspection and routine cleaning operations may be accomplished simply removing the front panel.
- **Hand-removable water distribution tube-** routine cleaning has never been so easy!
- **Embedded antimicrobial-** Ag-Ion® antimicrobial is present in selected food-zone components
- **External Components-** All external panel components are crafted for optimal aesthetic appeal through superior fit and finish
- **Reusable air filter** is easily removable from the outside for ease of cleaning (in air-cooled models)
- **California Energy Commission-** meets or exceeds CEC guidelines

MV606 Technologies

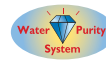

		21°: 15°C		32°: 21°C		 [WxDxH mm] 760x620x575 [WxDxH inches] 29 15/16" x 24 7/16" x 22 10/16"		
		[kg]	[lbs]	N°	N°*		[kg]	[lbs]
MV606 AS		280	617	29000	215	474	21500	 [v/Hz/ph] 220-240/50/1 R 404 a
MV606 WS		275	606	27500	240	529	24000	
MVH606 AS		290	639	48140	215	474	35690	 [v/Hz/ph] 220-240/50/1 R 404 a
MVH606 WS		275	606	45650	240	529	39840	
MVL606 AS		260	572	15300	200	440	11760	 [v/Hz/ph] 220-240/50/1 R 404 a
MVL606 WS		256	564	15050	223	490	13120	
MVHL606 AS		290	639	48140	215	474	35690	 [v/Hz/ph] 220-240/50/1 R 404 a
MVHL606 WS		275	606	45650	240	529	39840	

Half Large Cube - 6 g
 W 10 x D 24 x H 29 mm



Large Cube - 17 g
 W 29 x D 24 x H 29 mm

Half Dice Cube - 6 g
 W 11 x D 24 x H 22 mm



Dice Cube - 10 g
 W 22 x D 24 x H 22 mm

2 Years Warranty

Subject to certain limitations and exclusions

Certified ISO 9001:2000

www.scotsman-ice.it
www.scotsman-ice.com
www.scotsman-ice-on-tablet.com

Models and specifications are subject to change without notice.

Other models in this range:
 MV306 - MV426 - MV430
 MV456 - MV460
 MV806 - MV1006

MV Cube Ice Machines up to 320 Kg

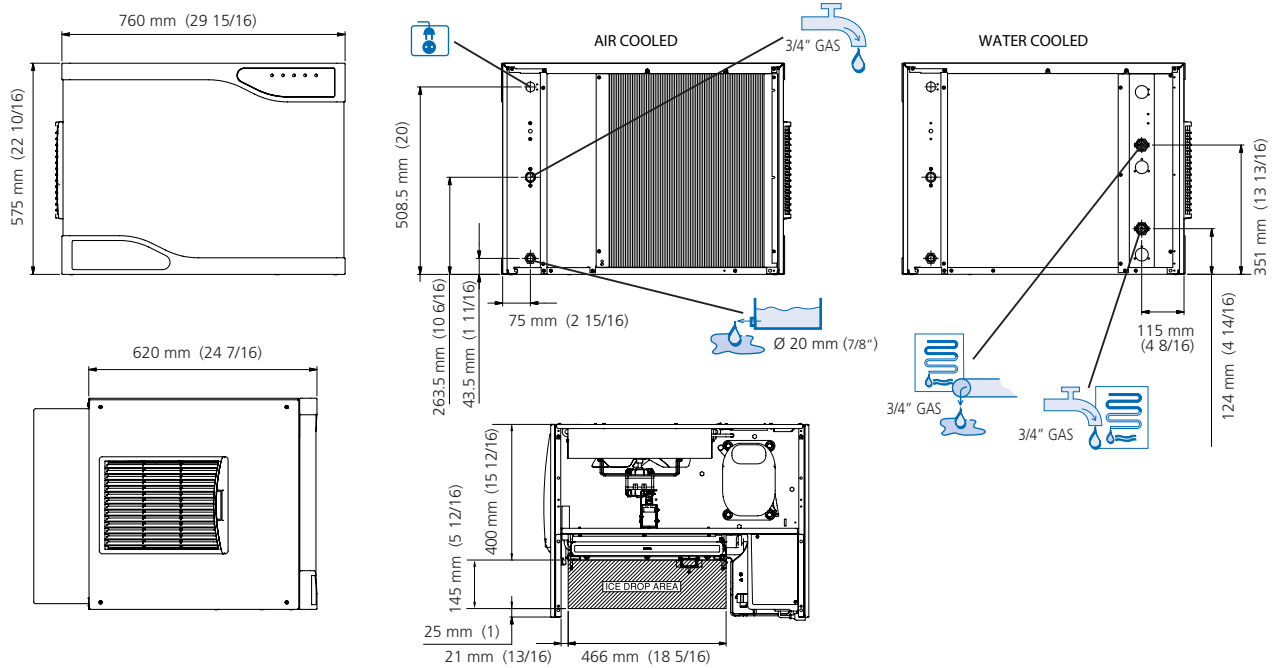

MV606 AIR COOLED

MV606 WATER COOLED

°C	°F		°C				kg	
	10°	50°	50°	60°	70°	90°		
10°	320	705	305	672	285	628	250	551
50°	290	639	280	617	265	584	235	518
21°	225	496	220	485	215	474	195	430
32°	192	423	189	417	185	408	175	386
38°	100	210	100	210	100	210	100	210

°C	°F		°C				kg	
	10°	50°	50°	60°	70°	90°		
10°	285	628	280	617	275	606	253	558
50°	275	606	270	595	265	584	245	540
21°	250	551	245	540	240	529	220	485
32°	245	540	240	529	235	518	215	474
38°	100	210	100	210	100	210	100	210

Minimum	Maximum
10°C (50°F)	40°C (104°F)
5°C (41°F)	35°C (95°F)
-10%	+10%
1 BAR 14 psi	5 BAR 70 psi

	Temperature Range	Capacity [Btu/h] [W]	Water Inlet [Ømm²]	Power [W]	FUSE	Ice Storage [kg] - 100 Kg	Water Inlet [l/h]	Water Inlet [gal/h]	Weight [kg] [lbs]	Dimensions [kg] [lbs]
MV606 AS	+C° -C°	13150 3860	3x1,5	1300	16 A	13	14,5	3,8	71 157	86 190
MV606 WS	Water	13150 3860	3x1,5	1050	16 A	9,6	137	36,2	71 157	86 190
MVH606 AS	+C° -C°	13150 3860	3x1,5	1300	16 A	13	14,5	3,8	71 157	86 190
MVH606 WS	Water	13150 3860	3x1,5	1050	16 A	9,6	137	36,2	71 157	86 190
MVL606 AS	+C° -C°	13150 3860	3x1,5	1300	16 A	13	14,5	3,8	71 157	86 190
MVL606 WS	Water	13150 3860	3x1,5	1050	16 A	9,6	137	36,2	71 157	86 190
MVHL606 AS	+C° -C°	13150 3860	3x1,5	1300	16 A	13	14,5	3,8	71 157	86 190
MVHL606 WS	Water	13150 3860	3x1,5	1050	16 A	9,6	137	36,2	71 157	86 190

CONTACT POINTS:

Europe
 Scotsman Europe-Frimont S.p.A.
 Ph/Fax +39-0293960208 / 0293960201
 scotsman.europe@frimont.it
 Paolo Moro

Middle East & N. Africa
 Scotsman-Frimont Regional Office (MENA)
 Ph/Fax +97-16 5262944 / 165262946
 m.dawood@frimont.ae
 fernando.m@frimont.ae

Asia and Pacific
 Scotsman Industries (S) PTE. L.T.D.
 Ph/Fax +65-67385393 / 67381959
 scotsman@scotsman.com.sg
 Andrea Tronci

South Africa
 Scotsman SA (Pty) Ltd - Ice Systems (Pty) Ltd
 Ph +27-0105900609 / 0877200245/6/7/8
 Fax: +27-118264123 / 0866340803
 stuart@scotsmansa.co.za - jennifer@scotsman.co.za

India
 Scotsman Group India
 Ph/Fax : +91-1244002459 / direct 9560072459
 david.owen@scotsman.com.sg

Spain
 Scotsman España, S.L.U. c/ Galapagar, 12
 Ph/Fax +34-911109796 / 916337423
 scotsman@scotsman-espana.es
 Daniel Doblado

China
 Scotsman Ice Systems (Shanghai)
 Ph/Fax : +86-2161313200 / 2161313330
 scotsman.shanghai@scotsman-china.com
 Andrew Clayton